



Posey® Omni Belt 4116PQ Application Instructions



Rx ONLY

DESCRIPTION OF PRODUCT: Self-releasing belt for wheelchair, hospital bed, or stretcher.

INTENDED USE:

- To protect patients by securing to wheelchair, hospital bed, or stretcher to provide a reminder not to self-ambulate without assistance by requiring the patient to release the device at the waist prior to exiting. For patients assessed to:
 - Be at risk of unassisted wheelchair or bed/stretcher exits.
 - Need a positioning device to assist with medical treatment.
- Follow your hospital's restraint policies and procedures that are compliant with USA CMS guidelines and state laws, or other governing agencies outside the USA.

CONTRAINDICATIONS: None.

⚠ CAUTION: RX REQUIREMENTS: This product is designed for self-release. If the patient is not able to easily self-release, the product is considered a restraint and must be prescribed by a physician. Refer to CMS Interpretive guidelines 482.3 (e)(1)(i)(A).

APPLICATION INSTRUCTIONS: WHEELCHAIR

1. Open the lap belt and position it as far back in the chair as possible.
2. Bring the ends of the connecting straps down at a 45° angle between the seat and sides of the wheelchair (Fig. 1).
3. Criss-cross the straps behind the chair and draw them around the opposite-side kick spurs (Fig. 2). Insert the strap ends through the white D-ring on each side and attach the hook-and-loop fasteners.
4. Use slide buckles to remove any slack. Check that the straps are secure and will not change position, loosen, or tighten if the patient pulls on them, or if the chair is tilted or adjusted.
5. Position the patient as far back in the seat as possible, with the buttocks against the back of the chair.
6. Place belt around patient at the smallest part of the waist, or just above the hips. Belt should be snug, but not cause any discomfort to the patient.
7. Use the quick-release buckle to adjust the lap belt. The belt must be snug, but not interfere with breathing. To check for proper fit, slide an open hand (flat) between the belt and the patient.

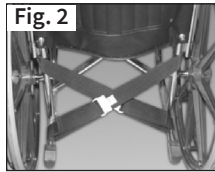
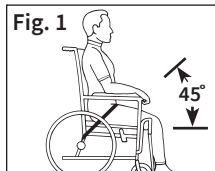

APPLICATION INSTRUCTIONS: HOSPITAL BED/STRETCHER

1. Open the belt and center it across the mattress.
2. Position the patient in bed with the belt at waist level.
3. Bring the belt around the patient's waist and connect the quick-release buckle.
4. Use the quick-release buckle to adjust the belt. The belt must be snug, but not interfere with breathing. To check for proper fit, slide an open hand (flat) between the belt and the patient.
5. Place side rails in the up position.
6. Feed the end of each connecting strap around the bed frame, at waist level. Insert the strap ends through the white "D" ring on each side, and attach the hook and loop fasteners. Make sure that the straps are attached to the frame that moves with the patient (do not attach to side rail or head/footboard) (Fig. 3), out of the patient's reach.
7. Use slide buckles to remove any slack. Check that the straps are secure and will not change position, loosen, or tighten if the patient pulls on them, or if the bed is adjusted.

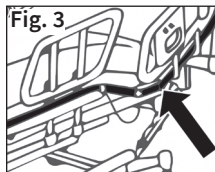

4116PQ

POSEY OMNI BELT:

REF 4116PQ Self-Releasing Omni Belt with Quick-Release Buckle (single strap hook & loop with D-Ring)

⚠ WARNING: Additional restraints may be needed (visit tidiproducts.com)

- A clinical assessment and decision are required when used with a wound or surgical site, ostomy, colostomy, G-tube, hernia, monitoring line, or other surgical drains/tubes.
- A restraint applied incorrectly may cause patient injury or escape. Never apply product backwards or criss-cross the straps behind the patient. Make sure the straps cannot slide, loosen, or tighten if patient pulls on them. Readjust straps if wheelchair, hospital bed, or stretcher position changes.
- Some patients may require additional interventions in conjunction with a restraint in order to prevent injury to self or others.
 - If the patient pulls violently against the straps.
 - To prevent the patient from flailing or bucking up and down, causing self-injury.
- Make sure patient wears proper undergarments to protect skin.
- It is a clinical decision to decide when a restraint is no longer deemed safe.

BED SAFETY: Refer to the Food and Drug Administration (FDA), or other governing agencies outside the USA, for the most recent Hospital Bed Safety Guidelines and the bed manufacturer's instructions for use.

PRECAUTIONS: None.

EN

ADDITIONAL SAFETY AND LAUNDERING INSTRUCTIONS ON OTHER SIDE.





For RX PRODUCTS ONLY. Federal law (USA) restricts RX devices to sale by or on order of a physician. For use in a licensed healthcare facility only.

STAFF TRAINING: TIDI offers in-service training aids at no charge. Contact TIDI online at www.tidiproducts.com or call toll-free at 1.800.521.1314.

BEFORE APPLYING ANY RESTRAINT: Follow your hospital's restraint policies and procedures that are compliant with USA CMS guidelines and state laws or other governing agencies outside the USA.

⚠️ ADDITIONAL WARNINGS:

1. ALWAYS monitor patient per facility policy. Improper application or use of any restraint may result in serious injury or death. Be aware that constant monitoring may be required for:
 - Aggressive or agitated patients; and
 - Patients in a supine position; ensure that being in this position would not cause any complications for those who are at risk of vomiting while being restrained.
2. NEVER alter or repair this product. ALWAYS inspect before each use: Check for broken stitches or parts; torn, cut or frayed material; or locks, buckles, or hook-and-loop fasteners that do not hold securely. DO NOT use soiled or damaged products. Doing so may result in serious injury or death. Dispose of damaged products per facility policy for BIOHAZARDOUS material.
3. ALWAYS secure straps to a part of the frame that moves with the patient (not foot/head board or siderails), out of the patients reach, using quick-release ties (see drawing below) or buckles. These allow easy release in the event of an accident or fire. Test to make sure straps cannot tighten, loosen, or slip and create excess slack. If this occurs, the patient may slide off the chair or bed, increasing the risk of serious injury or suffocation. Restraint release is an important part of facility fire and disaster drills. Straps can be cut with scissors in an emergency.
4. NEVER secure restraint strap to side rail or head/foot board.
5. NEVER use Posey products on toilets, or on any chair or furniture that does not allow proper application as directed in the Application Instructions. DO NOT use at home.
6. NEVER expose this product to open flame, fire, smoking materials, or high heat sources. Some products may melt or ignite and burn. The facility smoking/no smoking policy should be strictly enforced.
7. NEVER use a Posey product as a seat belt in a moving vehicle. Posey products are not designed to withstand the force of a crash or sudden stop.
8. Test Zippers or hook-and-loop fasteners before each use. DISCARD device if it does not fasten securely.

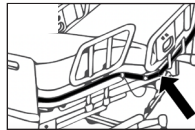

LAUNDERING INSTRUCTIONS (if applicable):

- Fasten all buckles and locks to reduce risk of damage during wash and dry cycles. DO NOT put buckles or locks through extractors. For maximum life, launder in a laundry bag.
- Stainless Steel Locks: Posey recommends that locks be treated with a dryfilm lubricant (silicone) after each cleaning. For best results, spray a small amount into the lock. Work the action of the lock with a key several times to ensure that all the surfaces are well lubricated.
- Before laundering, zip up and turn the product inside out to protect zipper.
- Hook-and-loop fasteners may collect lint after repeated use or laundering, reducing grip strength. Fasten the "hook" to the "loop" before laundering to help prevent lint buildup. As needed, use a stiff-bristle brush to remove lint from the "hook" side.

• These products, other than foam products, can be machine washed under CDC guidelines for material soiled with blood or bodily fluid.

- For non-contaminated material, use lower temperature wash and dry cycles to extend product life.

• For foam products:

- Make sure products are completely dry before use.

STORAGE AND HANDLING:

- This device is designed for use in normal indoor environments.
- This device may be stored in ambient warehouse temperatures at normal humidity levels. Avoid excess moisture or high humidity that may damage product materials.

HOW TO TIE THE POSEY QUICK-RELEASE TIE

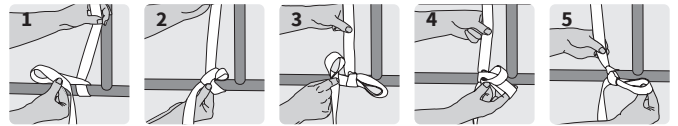

1. Wrap strap once around the frame that moves with the patient (do not attach to side rail or head/footboard), leaving at least an 8" (20 cm) tail. Fold the loose end in half to create a loop and cross it over the other end.
2. Insert the folded strap where the straps cross over each other, as if tying a shoelace. Pull on the loop to tighten.
3. Fold the loose end in half to create a second loop.
4. Insert the second loop into the first loop.
5. Pull on the loop to tighten. Test to make sure strap is secure and will not slide in any direction.
6. Repeat on other side. Practice quick-release ties to ensure the knot releases with one pull on the loose end of the strap.

DISPOSAL: Dispose of product according to local or facility guidelines if product is worn or damaged.