



Posey® Criss-Cross Vests 3311 Application Instructions



Rx ONLY

DESCRIPTION OF PRODUCT: Criss-cross vest with tie straps. For wheelchair, hospital bed, or stretcher use.

INTENDED USE:

- To protect patients by securing them to a wheelchair, hospital bed, or stretcher to limit unassisted exits and unwanted movement among patients assessed to:
 - Be at risk of unassisted wheelchair, hospital bed, or stretcher exits.
- Follow your hospital's restraint policies and procedures that are compliant with USA CMS guidelines and state laws, or other governing agencies outside the USA.

CONTRAINDICATIONS: None.

APPLICATION INSTRUCTIONS: Follow these steps to apply device.

1. Place the device on the patient with the "V" neck in front. Ensure side seams are located under the arms. If they are not, the sizing may be incorrect.
2. Position the straps in front of the patient and feed the strap from the patient's left side through the slot in the vest on the patient's right side.
3. See below instructions for wheelchair and/or bed application.
4. Slide an open hand (flat) between the device and the patient to ensure proper fit. The device must be snug, but not interfere with breathing.

APPLYING TO WHEELCHAIR:

1. Position the patient as far back in the seat as possible, with the buttocks against the back of the wheelchair.
2. Bring the straps over the hips at a 45° angle and pass down between the seat and the sides of the wheelchair (Fig.1).
3. Criss-cross the straps and use the quick-release ties to attach straps to the opposite-side kick spurs, out of the patient's reach (Fig. 2).

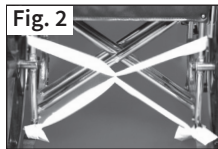
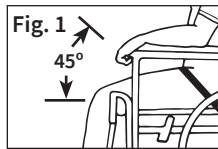

NOTE: If the wheelchair has an adjustable seat, secure straps to the section of the wheelchair that moves with the patient.

APPLYING TO BED:

1. Bring the ends of the strap down through the inside of the side rails so that they do not interfere when the side rails are raised. Make sure that the straps are attached to the frame that moves with the patient (do not attach to side rail or head/footboard) (Fig. 3), out of the patient's reach.
2. Thread the end of the strap over the top and around the frame at least once and attach with a quick-release tie. Check to ensure that the strap cannot slide in any direction or loosen if the patient pulls on it or if the bed is adjusted.

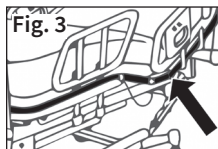

PRECAUTIONS: None.



POSEY CRISS-CROSS VESTS:

REF 3311M Breezeline Mesh Criss-Cross Vest (single strap; tie end); Medium

REF 3311L Breezeline Mesh Criss-Cross Vest (single strap; tie end); Large

WARNING: Additional restraints may be needed (visit tidiproducts.com)

- A clinical assessment and decision are required when used with a wound or surgical site, ostomy, colostomy, G-tube, hernia, monitoring line, or other surgical drains/tubes.
- A restraint applied incorrectly may cause patient injury or escape. Never apply product backwards or criss-cross the straps behind the patient. Make sure the straps cannot slide, loosen, or tighten if patient pulls on them. Readjust straps if wheelchair, hospital bed, or stretcher position changes.
- Some patients may require additional interventions in conjunction with a restraint in order to prevent injury to self or others.
 - If the patient pulls violently against the straps.
 - To prevent the patient from flailing or bucking up and down, causing self-injury.
- Make sure patient wears proper undergarments to protect skin.
- It is a clinical decision to decide when a restraint is no longer deemed safe.

BED SAFETY: Refer to the Food and Drug Administration (FDA), or other governing agencies outside the USA, for the most recent Hospital Bed Safety Guidelines and the Bed Manufacturer's instructions for use.

EN

ADDITIONAL SAFETY AND LAUNDERING INSTRUCTIONS ON OTHER SIDE.





For RX PRODUCTS ONLY. Federal law (USA) restricts RX devices to sale by or on order of a physician. For use in a licensed healthcare facility only.

STAFF TRAINING: TIDI offers in-service training aids at no charge. Contact TIDI online at www.tidiproducts.com or call toll-free at 1.800.521.1314.

BEFORE APPLYING ANY RESTRAINT: Follow your hospital's restraint policies and procedures that are compliant with USA CMS guidelines and state laws or other governing agencies outside the USA.

⚠️ ADDITIONAL WARNINGS:

1. ALWAYS monitor patient per facility policy. Improper application or use of any restraint may result in serious injury or death. Be aware that constant monitoring may be required for:
 - Aggressive or agitated patients; and
 - Patients in a supine position; ensure that being in this position would not cause any complications for those who are at risk of vomiting while being restrained.
2. NEVER alter or repair this product. ALWAYS inspect before each use: Check for broken stitches or parts; torn, cut or frayed material; or locks, buckles, or hook-and-loop fasteners that do not hold securely. DO NOT use soiled or damaged products. Doing so may result in serious injury or death. Dispose of damaged products per facility policy for BIOHAZARDOUS material.
3. ALWAYS secure straps to a part of the frame that moves with the patient (not foot/head board or siderails), out of the patients reach, using quick-release ties (see drawing below) or buckles. These allow easy release in the event of an accident or fire. Test to make sure straps cannot tighten, loosen, or slip and create excess slack. If this occurs, the patient may slide off the chair or bed, increasing the risk of serious injury or suffocation. Restraint release is an important part of facility fire and disaster drills. Straps can be cut with scissors in an emergency.
4. NEVER secure restraint strap to side rail or head/foot board.
5. NEVER use Posey products on toilets, or on any chair or furniture that does not allow proper application as directed in the Application Instructions. DO NOT use at home.
6. NEVER expose this product to open flame, fire, smoking materials, or high heat sources. Some products may melt or ignite and burn. The facility smoking/no smoking policy should be strictly enforced.
7. NEVER use a Posey product as a seat belt in a moving vehicle. Posey products are not designed to withstand the force of a crash or sudden stop.
8. Test Zippers or hook-and-loop fasteners before each use. DISCARD device if it does not fasten securely.

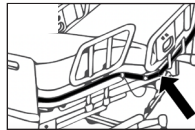

LAUNDERING INSTRUCTIONS (if applicable):

- Fasten all buckles and locks to reduce risk of damage during wash and dry cycles. DO NOT put buckles or locks through extractors. For maximum life, launder in a laundry bag.
- Stainless Steel Locks: Posey recommends that locks be treated with a dryfilm lubricant (silicone) after each cleaning. For best results, spray a small amount into the lock. Work the action of the lock with a key several times to ensure that all the surfaces are well lubricated.
- Before laundering, zip up and turn the product inside out to protect zipper.
- Hook-and-loop fasteners may collect lint after repeated use or laundering, reducing grip strength. Fasten the "hook" to the "loop" before laundering to help prevent lint buildup. As needed, use a stiff-bristle brush to remove lint from the "hook" side.

• These products, other than foam products, can be machine washed under CDC guidelines for material soiled with blood or bodily fluid.

- For non-contaminated material, use lower temperature wash and dry cycles to extend product life.

• For foam products:

- Make sure products are completely dry before use.

STORAGE AND HANDLING:

- This device is designed for use in normal indoor environments.
- This device may be stored in ambient warehouse temperatures at normal humidity levels. Avoid excess moisture or high humidity that may damage product materials.

HOW TO TIE THE POSEY QUICK-RELEASE TIE

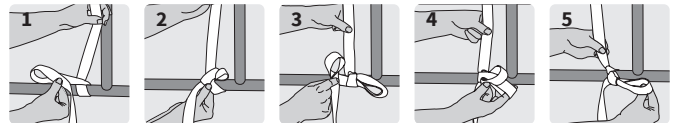

1. Wrap strap once around the frame that moves with the patient (do not attach to side rail or head/footboard), leaving at least an 8" (20 cm) tail. Fold the loose end in half to create a loop and cross it over the other end.
2. Insert the folded strap where the straps cross over each other, as if tying a shoelace. Pull on the loop to tighten.
3. Fold the loose end in half to create a second loop.
4. Insert the second loop into the first loop.
5. Pull on the loop to tighten. Test to make sure strap is secure and will not slide in any direction.
6. Repeat on other side. Practice quick-release ties to ensure the knot releases with one pull on the loose end of the strap.

DISPOSAL: Dispose of product according to local or facility guidelines if product is worn or damaged.